

Porta Westfalica June 2010

For all ambitions and all budgets

Rodenberg develops new all-glass panel product line



The trend toward all-glass panel in entrance doors is still unbroken. Hardly surprising, because all-glass door conform to the wish for transparency and a high incidence of light in the entrance area. They fascinate by smooth, glossy surfaces and combine elegance and unbeatably easy care. Rodenberg Türsysteme AG meet the increasing demand in this market segment with

a newly developed all-glass-panel program as well as with the new edition of the catalog "Glass and Elegance". Not only has the model range been extended to 72 insert- and attachment panels, but also the prices have been rounded down in the upper and lower price levels. In order to meet all tastes and financial requirements Rodenberg offers a big variety of all-glass panels.

New separate all-glas catalog

This becomes apparent if you page through the 56-page all-glass catalog where four product-series stand for different refinement techniques and price-levels: from color coated attachment panels of the series PremiumLine over the lacquered models of the series ColorLine up to the matted, sandblasted panels of the series MediumLine and SmartLine. According to each model the refined

Rodenberg
Türsysteme AG
Osterkamp 3
D-32457 Porta Westfalica

Tel.: +49 5731/768-0
Fax: +49 5731/768-180

info@rodenbergmail.de
www.rodenberg.ag

Blatt 2

glasses out of the own glass-production will be delivered as double- or triple-glazing with 4 mm or 6 mm WSG (heat protecting glass) as inside pane.

Highly thermal-insulating panels by new material combinations

The covered glass-panels of the product line PremiumLine fulfill highest quality requirements, which are available in the actual trend-colors steel blue, magenta, silver-grey and anthracite grey. The production takes place in the classic screen printing method. In this technique the colors are brought on the inside of the external pane and connected permanently with the glass surface. The result are glasses with an extraordinary brilliance and high luminance. To intensify this effect and at the same time accommodate to the safety requirements Rodenberg uses high value, color neutral ESG (one-pane-safety-glass). The so-called white glass - without the glass-typical light green tint - lets the

- 1 Äußere Scheibe ESG mit farbiger Beschichtung
- 2 Teilflächen mattiert/klar
- 3 Wärmedämmkern
- 4 Mittlere Scheibe ESG
- 5 Innere Scheibe WSG
- 6 Innen Oberfläche Kunststoff oder Aluminium

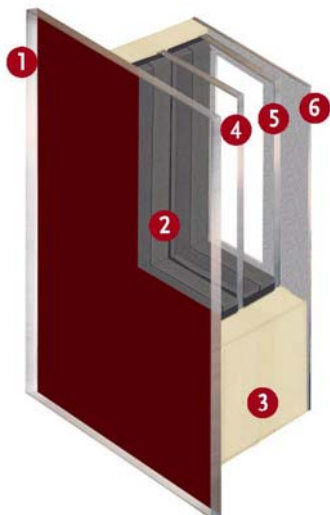

color-coated areas shine even more brilliant. In the series PremiumLine you find in addition to attachment panels with the revolving wing covering coating also extensively coated, highly thermal insulation all-glass panels. These panel versions stand out due to sophisticated material-combinations according to the principle of the classical sandwich panel-construction. On the outside of the models ESG (one-pane-safety glass) is used, whereas the inside – according to the material of the doorframe – consists of a synthetic- or aluminium coating. In combination with an internal thermal insulation core from highly

Rodenberg
Türsysteme AG
Osterkamp 3
D-32457 Porta Westfalica

Tel.: +49 5731/768-0
Fax: +49 5731/768-180

info@rodenbergmail.de
www.rodenberg.ag

Blatt 3

insulating rigid foam, the innovative all-glass panels set new benchmarks in relation to energy efficiency.

Lacquered all-glass-panels in all RAL-colors



Also the lacquered panels from the series ColorLine convince by brilliant color- and glossy effects, as well as by their manufacturing out of color-neutral ESG. For these models special covering glass-lacquers are used, which are applied on the backside of the outside panel. All-glass panels with opaque lacquer coatings open up a variety of scopes for design, particularly because they are available in all current RAL-

colors. Who on the contrary likes the fascinating interplay of matted and clear glass, can choose between 44 models from the series MediumLine and SmartLine, which are refined by the sandblast technique. Special attention is given here to the six new Feng Shui-models. The all-glass models designed according to principles of the Feng Shui doctrine reflect the five elements wood, fire, earth, metal, water, as well as the energy powers Ying and Yang.

Design with a lot of love to the detail

Modern, up to date and innovative design marks the models of the new all-glass program of Rodenberg. Created by Katja Neumann, a designer who is employed with the company. As a central theme the clear and minimalist stylistic elements of the graduated designer and art-glazier master draw a continuous line through the catalog "Glass and Elegance". Not only is the aesthetic demand reflected in the design of all doors, but especially the small and sophisticated details are giving

Rodenberg
Türsysteme AG
Osterkamp 3
D-32457 Porta Westfalica

Tel.: +49 5731/768-0
Fax: +49 5731/768-180

info@rodenbergmail.de
www.rodenberg.ag

Blatt 4

this program a very special note. This is proved by the variety of applications in the double-glazing cavity: from sparkling Swarovski crystals and hand grinded glass stones, via design-elements from black color-glass or prominent stainless steel visual appearance up to filigree glass- and facet stones.

Rodenberg
Türsysteme AG
Osterkamp 3
D-32457 Porta Westfalica

Tel.: +49 5731/768-0
Fax: +49 5731/768-180

info@rodenbergmail.de
www.rodenberg.ag